

THERMAL BINDING WITH DROP&GO TECHNOLOGY

Bindomatic® 7000 System

Automated, highly efficient document binding



Bindomatic's Drop&Go Technology makes the new Bindomatic® 7000 System substantially faster than punch & bind and tape binding. Its efficiency — rivaled only by the Bindomatic® 9000 — binds documents at an incredible rate. The 7000 System features additional upgrades including increased quality and strength of the bound documents as well as improved appearance of the machine.

Built on the stability and technology of the 101DFS, which launched in 2003, the 7000 System is the ideal binding solution for office/corporate walk-up print stations, as well as volume demanding CRD or commercial print environments. It delivers professionally-bound documents, without the need of trained operators.

DOCUMENT SIZE

A4 — portrait bound orientation

SYSTEM CAPACITY

From 1 to 150 sheets of 80 gsm paper.

Performance is subject to user environment.

DOCUMENT SPINE WIDTH

from 1.5 to 15 mm

MACHINE DIMENSIONS

L 511 x W 475 x H 360mm

MACHINE WEIGHT

28 kg

POWER SUPPLY

230V, 50/60Hz



BONUS! System includes additional desktop unit for editing

The Bindomatic® 7000 is available for lease.
Contact your Binding Efficiency Expert for details.



BINDOMATIC®
BINDING EFFICIENCY EXPERTS

HOW DROP&GO WORKS

360°
VIEW

A. FRONT AND LEFT SIDE

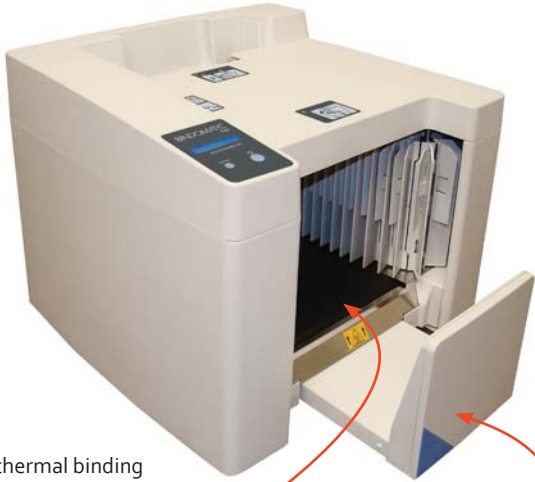

The thermal binding belt fuses your document pages and covers together in seconds, then moves the finished documents to the cooling tray.

The cooling tray expands to accommodate your documents as they emerge; bound and ready to use.

B. BACK AND RIGHT SIDE

Once pages are placed in the automatic cover size selector, the machine will display the correct cover spine width to use.



C. OVERHEAD

Step-by-step, easy to follow instructions are on every Bindomatic 7000.



Insert unbound documents (up to 150 sheets) and covers into the 7000

1. Insert the set of papers to be bound in the automatic cover size selector. The display will show the correct cover spine width to use.

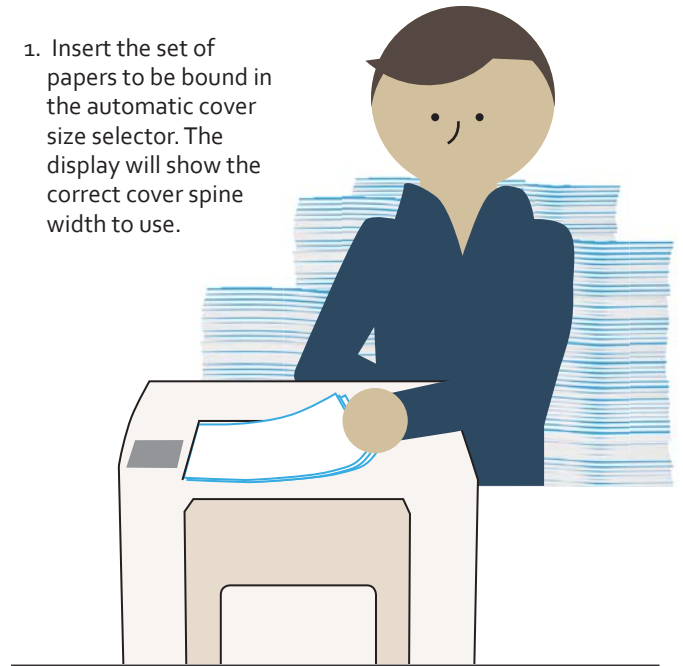

2. Place document pages in a Bindomatic cover, with the correct spine size, and align.

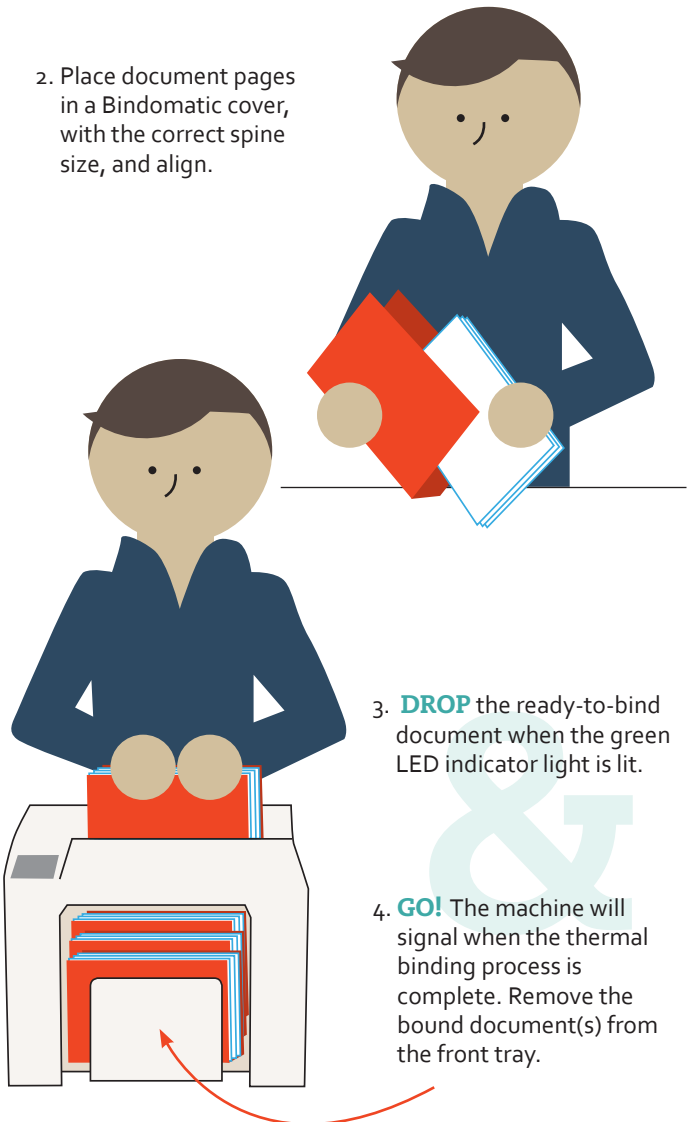

3. **DROP** the ready-to-bind document when the green LED indicator light is lit.

4. **GO!** The machine will signal when the thermal binding process is complete. Remove the bound document(s) from the front tray.